



1. All interior columns, caps and bases must be primed with one (1) coat of primer and then painted with one (1) coat of paint. **NOTE:** While both latex and oil-based products may be used for interior applications, oil-based products have better adhesion. Follow the paint manufacturer's instructions for best results. Wood caps & bases are not vented and should not be used for exterior use.

**STORAGE**

- ✓ Store all wood columns in an area that is cool, dry and well ventilated.



2. Drop a plumb bob from the center of the soffit to determine the column's center point on the floor. Mark this point for reference to align the shaft in the proper position.



3. Make sure the plinth is level before continuing with the installation.

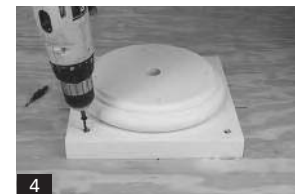

4. Pre-drill and countersink holes through the base and into the floor. Secure the base to the floor with rust resistant screws.



5. Measure the overall opening height. Subtract the height of the base and capital from the overall opening height to determine the shaft length.



6. If trimming is necessary, trim from the base of the shaft. The load must be evenly distributed around the entire column circumference



7. Apply a bead of paintable silicone sealant around the top perimeter of the base and place the shaft on top of the base.



8. Pre-drill and countersink holes at an angle through the shaft into the base. Install rust resistant screws to secure the shaft to the base. Remove any excess silicone sealant.



9. Place the capital on the shaft and pre-drill and countersink holes at an angle through the shaft into the capital. Install rust resistant screws to secure the shaft to the capital.



10. Be sure the shaft is centered under the soffit. Use shims to secure the capital in position under the soffit.



11. Pre-drill and countersink holes through the capital and into the soffit. Install rust resistant screws to secure the capital to the soffit.

- ✓ All joints must be sealed with paintable silicone sealant.
- ✓ All countersunk screw holes should be filled with wood filler and sanded.
- ✓ Finish the column by applying a final coat of paint.