

fiberglass capitals and bases with wood plugs

7

STORAGE

✓ Store all wood columns in an area that is cool, dry and well ventilated.

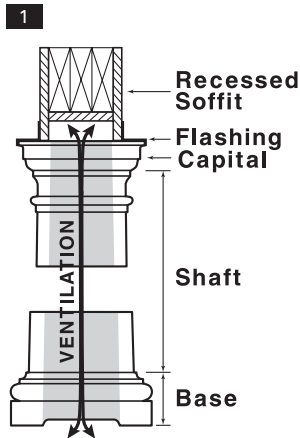

1. Adequate ventilation is a necessity in the installation of wood columns. Ventilation must be provided for at the top of the column by a recessed soffit. Ventilation will be provided at the bottom of the column by the precut openings in the plinth.



2. All columns must be primed with one (1) coat of exterior oil-based primer and then painted with one (1) coat of exterior oil-based paint prior to installation. Apply the primer and paint with a brush to best protect the column from moisture. Follow the paint manufacturer's instructions for best results. Fiberglass capitals and bases are shipped with wood plugs which must be primed and painted to protect from moisture.

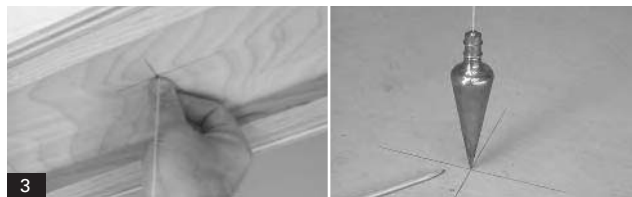

3. Drop a plumb bob from the center of the soffit to determine the column's center point on the floor. Mark this point for reference to align the column in the proper position under the soffit.



4. Level the plinth to the floor, making sure the ventilation area is maintained. The ventilation area may need to be enlarged after leveling the plinth.

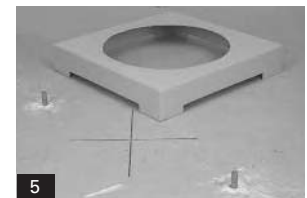

5. The fiberglass plinth is secured to the floor using rust resistant dowels. Place two dowels in opposite corners to prevent lateral movement of the plinth. Mark and drill two holes in the floor where the dowels will align the plinth.



6. Position the base wood plug in the center of the fiberglass plinth. Check to insure the plug is level.



7. If the base wood plug is not level, remove the plastic pads from the bottom of the legs. Trim the legs as necessary to level the base wood plug and reattach the plastic pads.

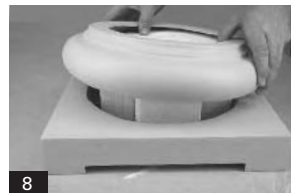

8. Place the base molding over the base wood plug to test the fit. Be certain the load is carried by the base wood plug, not the fiberglass base molding and plinth.



9. Apply a bead of construction adhesive around the bottom of the fiberglass base molding and press into place over the wood plug. Allow sufficient drying time for the adhesive.



10. Measure the overall opening height. Subtract the height of the base and capital wood plug from the overall opening height to determine the shaft length. Raise the soffit slightly with a sturdy brace to hold the soffit in position during installation.



11. If trimming is necessary, trim from the base of the shaft. The load must be evenly distributed around the entire column circumference.



12. The end grain at the bottom of the shaft must be sealed and painted with oil based coatings to protect the column from moisture.



13. Center the capital wood plug on top of the shaft and attach with rust resistant screws.



14. Place the fiberglass capital over the plug and press into place. Attach the capital to the plug by installing rust resistant screws through the top of the capital into the plug.

fiberglass capitals and bases with wood plugs (continued)

7



15. Apply a bead of paintable silicone sealant to the joint between the fiberglass capital and the shaft.



16. Apply a bead of paintable silicone sealant around the top perimeter of the base molding. Erect the shaft with the attached capital assembly onto the base.

Be sure the capital is centered under the soffit. Remove any bracing and allow the load to bear on the column. When in proper position; (a) The top and bottom of the column shaft will fit evenly with the adjoining surface. There will not be any voids or distortions between the shaft and the adjoining surface. (b) The load will rest evenly around the entire circumference of the column shaft.

NOTE: Do not finish the installation unless both (a) and (b) are achieved.



17. Pre-drill and countersink holes at an angle through the shaft into the base wood plug. Install rust resistant screws to secure the shaft to the base wood plug. Remove any excess paintable silicone sealant.



18. Pre-drill and countersink holes at an angle through the soffit into the capital wood plug.

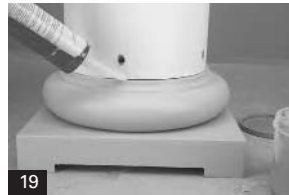

19. All joints must be sealed with paintable silicone sealant. All countersunk screw holes should be filled with wood filler and sanded.



20. Finish the column by applying a final coat of exterior oil-based paint.

SPECIAL NOTE

If building codes specify uplift protection, additional hardware is required. Crown recommends Simpson Strong-Tie anchor tie down hardware. Simpson Strong-Tie's toll free number is 800-999-5099. Follow the manufacturer's instructions when installing the hardware.